

# *Duster* 3000

## Operations & Maintenance Manual



## **Congratulations!**

By choosing the Island Clean Air Duster 3000, you have acquired a lifetime of clean air! The Duster 3000 was developed after years of research and development to find a solution to the problem of poor indoor air quality. Constructed of only the highest quality components, the Duster 3000's mobility, ability to circulate shop air, and four stage filtration process represent a dramatic breakthrough in the application of modern air cleaning technology. The instructions on the following pages will walk you through the setup and operation of the Duster 3000.

## **Parts Diagram**

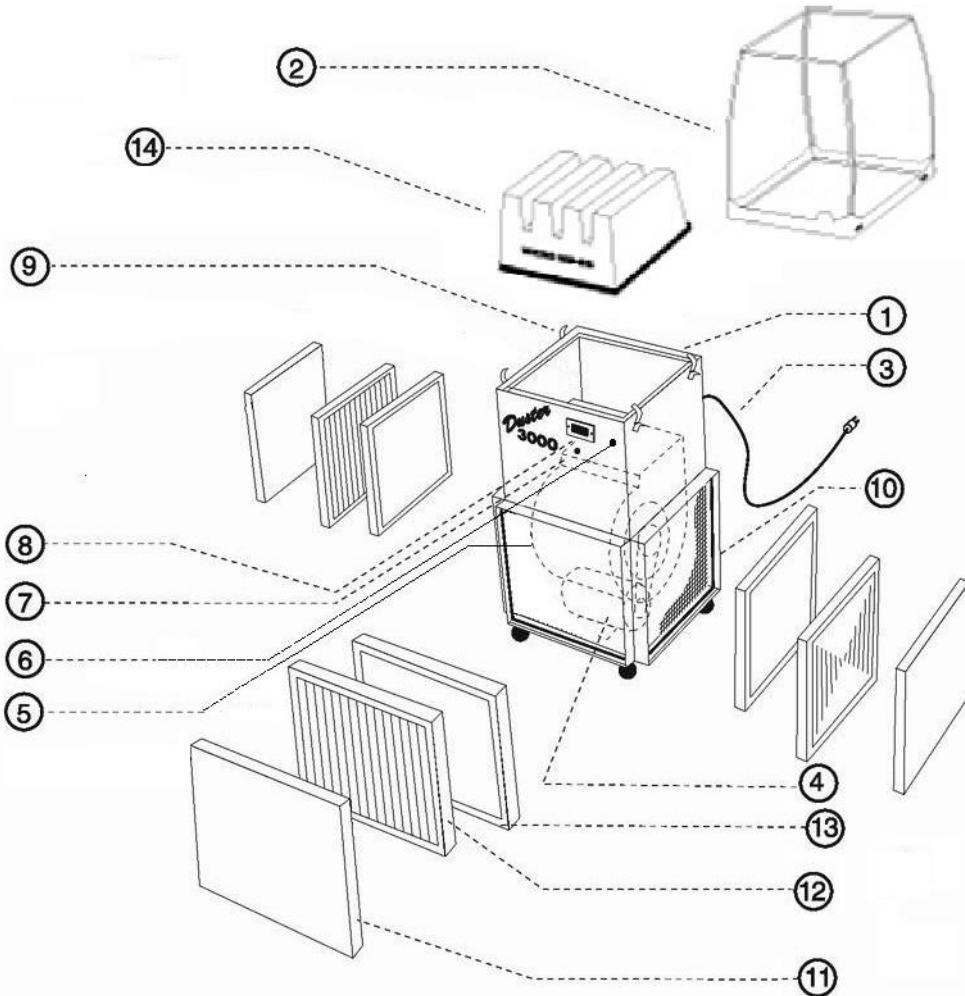

## **Parts List**

- |                            |  |
|----------------------------|--|
| 1: Housing Assembly        | 9: Quick Release Latches   |
| 2: Lexan Top Filter Shroud | 10: Rubber Filter Seals  |
| 3: Power Cord              | 11: Green Pre-Filter Pad   |
| 4: Motor                   | 12: HP90 Pleated Intake Filter                                     |
| 5: Blower                  | 13: CF2R Activated Carbon Filter                                   |
| 6: On/Off Power Switch     | 14: MP85 Top Filter (or optional AC24 Activated Carbon Top Filter) |
| 7: 2 Light Indicator Panel |  |
| 8: Digital Airflow Gauge   |  |

## **Warnings Before Use:**

- The operation of this unit does not exclude the proper use of industry approved respirators and Island Clean Air Inc. cannot guarantee health benefits.
- This machine is not to be used in hazardous locations, where explosive, combustible, corrosive, or conductive dust, vapors, or gases are present.
- Use of the Duster 3000 without filters or with non-ICA branded filters will void the warranty.

## **Duster 3000 Setup Step 1: Uncrate the Duster 3000**

- Remove all the screws from the front two 2"x3" wooden support uprights and front wooden panels with a #2 Philips screwdriver or power tool.
- Remove the two 2"x3" wooden support uprights.
- Roll the Duster 3000 off the skid.
- Remove the plastic bag.

## **Duster 3000 Setup Step 2: Install the Intake Filters**

- Remove the three intake filters from their boxes.
- Insert the intake filters in front of the preinstalled carbon filters. Make sure that the black Velcro pull tabs attached to the carbon filters are not pinched between the filters.
- Secure the intake filters with the Velcro tabs located on both sides of each filter.



**Correct**



**Incorrect**

- Proper sealing of the intake filters will prevent dirty air from bypassing the metal framed intake filters. Improper sealing will plug up the carbon filters and the top filter.

## **Duster 3000 Setup Step 3: Plug in the Duster 3000**

- Locate an electrical outlet that is capable of handling the Duster 3000:
  - 110-120Vac, 12A, 60Hz, 1Ph
- If connected to a circuit protected by 15A fuses, use delay fuses marked "D".
- Make sure your electrical power panel is capable of handling a 12A load in addition to your current usage. Overloading your panel may not allow the Duster 3000 to function correctly or to its full airflow capacity.
- Roll the Duster 3000 into position, plug it in, and turn it on.

## Digital Airflow Gauge / Operating Lights

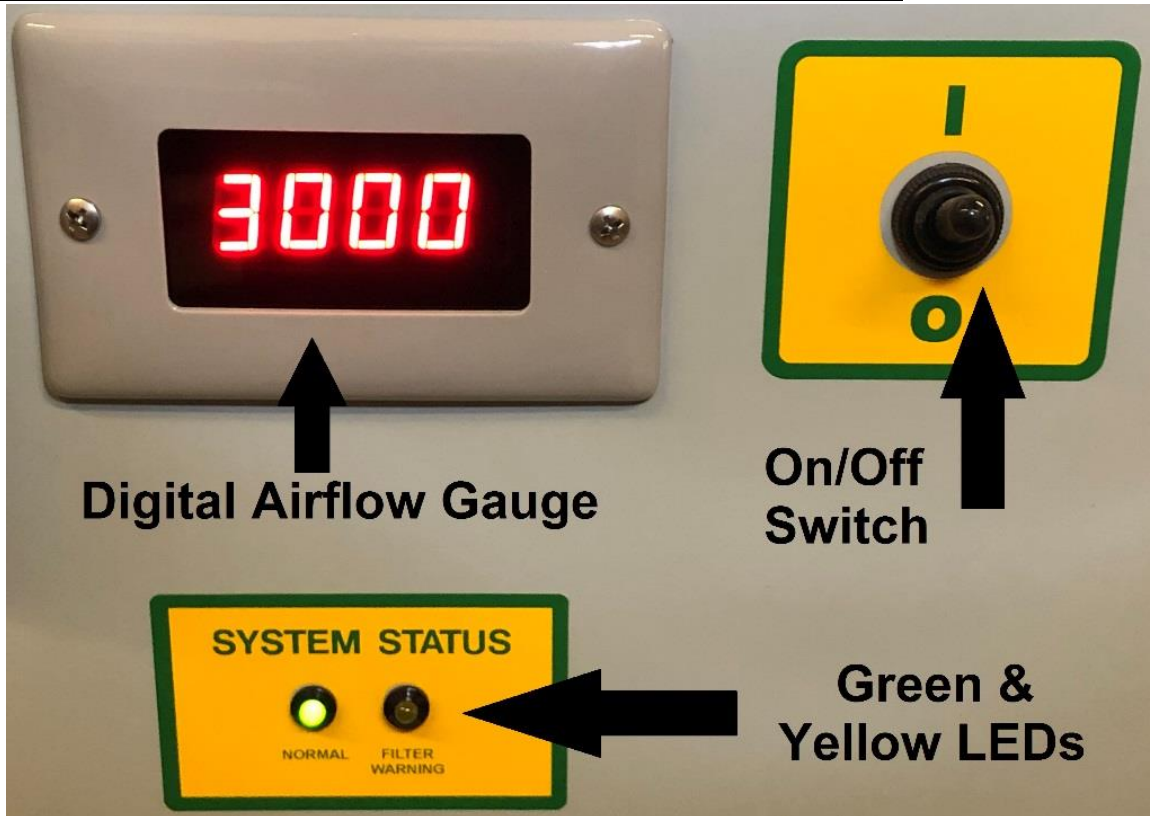

- The digital readout indicates the airflow volume in cubic feet per minute (CFM).
- Optimal airflow with clean filters should be over 3000 CFM.
- As the filters trap particles, the CFM will drop.
- The green light indicates that the machine is on and is in good working order.
- The yellow light indicates that the filters are dirty and need cleaning or replacing.
- The Duster 3000 will automatically shut down when the yellow light comes on to prevent permanent damage to the motor.
- The yellow light has been factory preset to go off around 2300 CFM or lower.

## **Island Clean Air Filters**

Each ICA filter has been engineered to provide maximum filtration with calibrated velocities to capture harmful airborne particulates. Using non-ICA branded filters in the Duster 3000 will: not seal properly, impede airflow, jeopardize employee safety, interfere with the sensitive calibration of the unit's monitoring system, and void the warranty. Be sure to turn the Duster 3000 off before removing or cleaning any filters.

**\*\*\* Proper Cleaning & Maintenance  
Will Prolong Filter Life \*\*\***

### **Lower Filters**

The Duster 3000 has three sets of filters around the base of the unit. These perform the majority of the air filtration and require routine maintenance.



#### **Green Pre-Filter Pad (Part #11703)**

- Filters dust and large particles.
- Clean daily or weekly.
- Clean by vacuuming the front of the green pad. Remove from intake filter and blow out with compressed air. Do not pressure wash.



#### **Pleated Intake Filter (Part #11204)**

- Filters dust and particles down to 1 micron.
- Clean daily or weekly.
- Clean by unhooking the Velcro straps on the sides and removing from the Duster 3000. Remove green pad. Vacuum pleats and/or blow with compressed air.



#### **Activated Carbon Filter (Part #11406)**

- Absorbs VOCs, fumes, and odors.
- Not cleanable.
- Replace when it weighs over 25lbs.

## **Top Filters**

The Duster 3000 has two options for the top filter. The standard unit has the MP85 Top Filter and the Fume Control unit has the AC24 Activated Carbon Top Filter for additional fume absorption.



### **MP85 Top Filter (Part #11602)**

- Filters smaller particles down to 0.3 microns.
- Not cleanable. As it gets dirty, it will slowly change color from white to dark gray.
- Replace when airflow is too restricted.

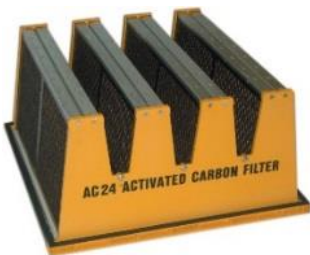

### **AC24 Activated Carbon Top Filter (Part #11401)**

- Absorbs VOCs, fumes, and odors.
- Not cleanable.
- Replace when it weighs over 47lbs.

## **Top Filter Replacement**

1. Open the four latches located on the sides of the Duster 3000
2. Lift and remove the Lexan top filter shroud.
3. Lift and remove the old top filter and replace with new top filter.
4. Reinstall Lexan top filter shroud.
5. Close the four latches.

## **General Maintenance**

- Once a year, we recommend a general cleaning by removing all filters and using compressed air to blow out any accumulated dust on and in the Duster 3000.
- The metal surfaces and Lexan top filter shroud can be wiped with warm water and detergent, avoiding the electronic components.

## **Troubleshooting**

The Duster 3000 is designed to run when connected to an adequate power supply and with all filters installed and cleaned. Most issues can be solved by:

- Ensuring adequate power is supplied to the unit (15A at 110V). We highly suggest using an isolated circuit so that the unit does not have to share power with other equipment.
- Ensuring all filters are installed correctly.
- Ensuring all filters are adequately cleaned and replaced when necessary.

If the above does not solve the issue, please contact ICA at 1-800-661-8211.

## **Warranty**

In order to validate your warranty, the Warranty registration card must be completed and returned to ICA.

All products made by ICA are warranted to be free of defects in materials and workmanship for a period of one (1) year from the date of original purchase.

This limited warranty does not include filters, cleaning, or damages caused by neglect or misuse and will cease if the product is resold, rented, or otherwise disposed of. Only factory original filters are recommended for use with this product. The use of any other filters not specifically approved of or sold by ICA may affect the performance and safety of the product and will void this warranty.

In no event shall ICA be liable for any indirect, incidental or consequential damages from the sale or use of this product. ICA does not guarantee health benefits. This applies both during and after the term of this warranty.





ISLAND CLEAN AIR

Choose the Air you breathe



**ISLAND CLEAN AIR INC.**

#101 - 326 E. Kent Avenue South  
Southbridge Business Park, Vancouver, BC, V5X 4N6, Canada

Tel: (604) 322-2979 • Fax: (604) 322-8674

Email: [info@islandcleanair.com](mailto:info@islandcleanair.com) • Website: [www.islandcleanair.com](http://www.islandcleanair.com)



Committed to Green



ATEX Approved



C US  
CSA Certified



Air Resources Board